

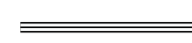

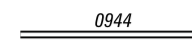

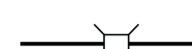

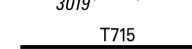



LEGEND

-  LIMITED ACCESS HIGHWAY
-  STATE ROUTE AND NUMBER
-  STATE MAINTAINED BRIDGE ON TOWNSHIP ROAD
-  TOWNSHIP ROAD, NUMBER AND SEGMENT LENGTH IN MILES
-  IMPASSABLE TOWNSHIP ROAD
-  OTHER ROAD
-  RAILROAD (IN SERVICE)
-  RAILROAD ABANDONED (TRACK RETAINED)
-  STATE BOUNDARY
-  COUNTY BOUNDARY
-  TOWNSHIP BOUNDARY
-  CITY OR BOROUGH BOUNDARY

-  MUNICIPAL BUILDING
-  SPLIT MILEAGE BETWEEN MUNICIPALITIES

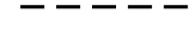
-  Stormwater Drainage and Residential Leaf Collection Areas
-  Stormwater Drainage Leaf Collection Only Areas

- 300 PARK DR
- 301 COWDEN AV
- 302 RIVERVIEW DR
- 303 MAGNOLIA LA
- 304 GRANT ST
- 305 HAAS MANOR RD
- 306 LAURELWOOD DR
- 307 GEISE ST
- 308 ELM ST
- 309 GUYER AV
- 396 SHOOK RD
- 400 EDISON HEIGHTS RD
- 446 HEMLOCK ST
- 503 DEWART ST
- 507 GREEN ST
- 509 SAW MILL RD
- 511 CAMP RD
- 517 ZIMMERMANS HOLLOW RD
- 525 NORTH ST
- 526 WEST ST
- 527 COLD RUN RD
- 528 GEARHART AV
- 529 MOUNTAIN VIEW RD
- 530 MUNGO AV
- 531 EAST DR
- 532 CLEMENS RD
- 533 RENNS RD
- 535 CAMPBELL RD
- 537 CHURCH RD
- 539 OAK ST
- 540 FARVIEW AV
- 541 WOODLAND DR
- 542 SHEFFIELD DR
- 543 OAKLYN ST
- 544 WOODSIDE RD
- 545 AUGUSTA RD
- 546 BROADWAY ST
- 547 CHERRY ST
- 548 UNION ST
- 549 FIRST AV
- 550 MAPLE LA
- 551 CENTRAL RD
- 552 PINE AV
- 553 ISLAND BLVD
- 554 CORCYRA RD
- 555 SECOND AV
- 556 PONTIUS AV
- 557 THIRO AV
- 558 SUN VALLEY DR
- 559 WHITE BIRCH RD
- 560 HILL ST
- 562 RIDGE RD
- 564 MAIN ST
- 592 ELDA ST
- 651 TWIG LA
- 653 MOUNTAIN TR
- 690 EPLER RD
- 691 MT PLEASANT RD
- 694 BENNICK RD
- 696 TOWER RD
- 698 COLD RUN HOLLOW RD
- 699 MILL RD
- 704 WEST FOX RD
- 706 KELLER RD
- 708 BASSETT RD
- 716 CHEVANTK RD
- 719 HILLSIDE DR
- 720 KEEFER RD
- 722 ANTHRACITE RD
- 731 CLIFF RD
- 732 CLAY POND RD

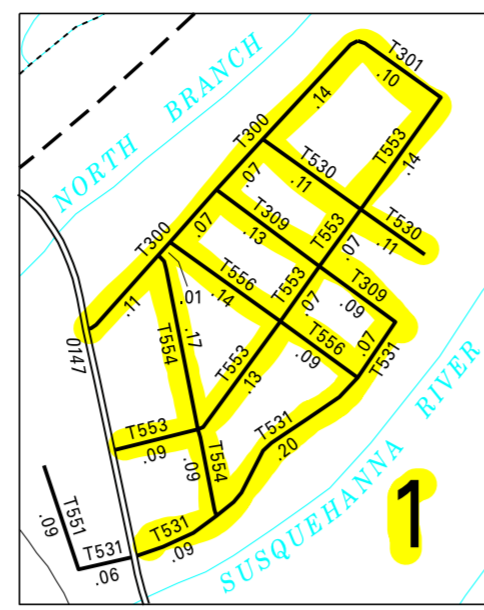

2:1

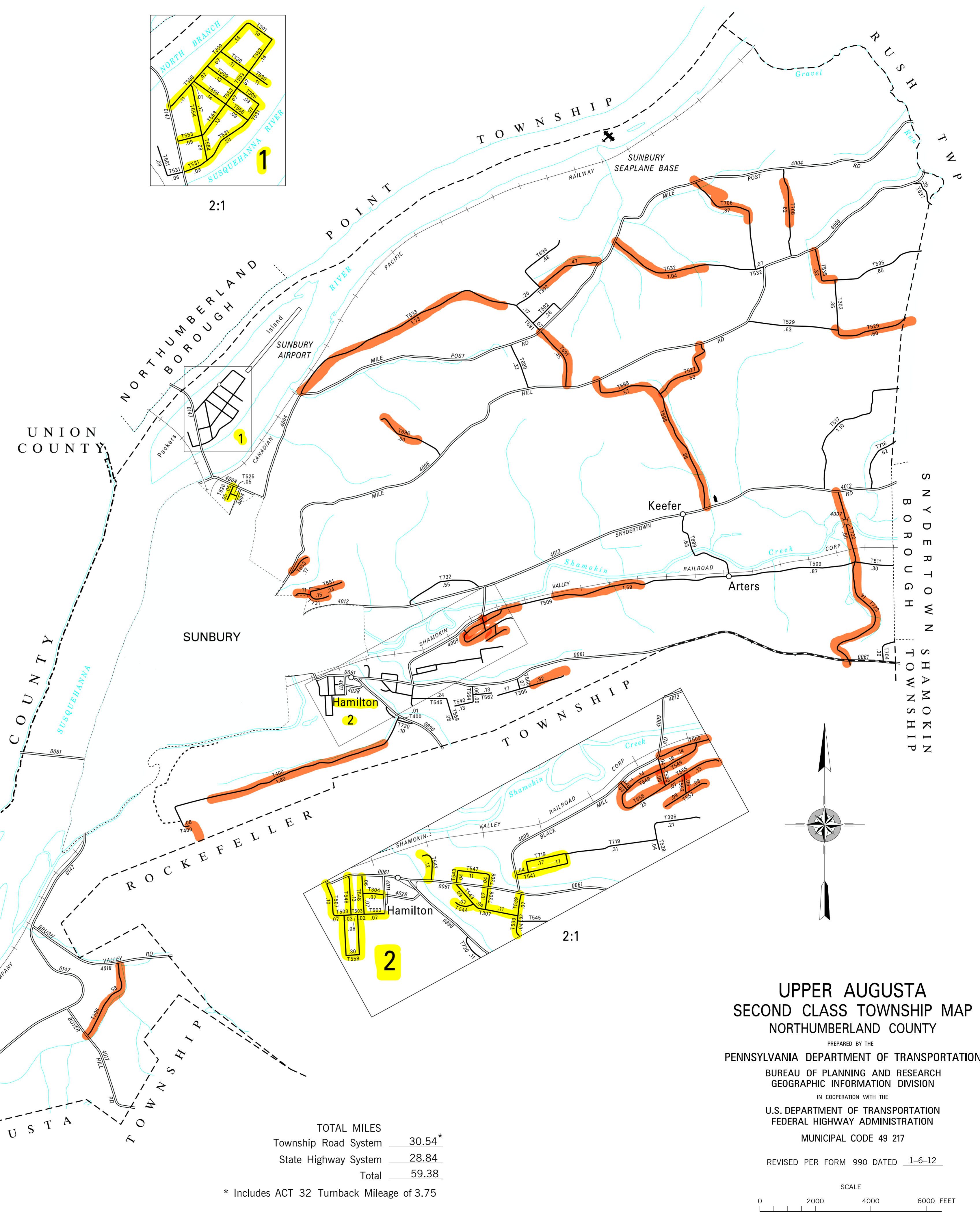

TOTAL MILES	
Township Road System	30.54*
State Highway System	28.84
Total	59.38

* Includes ACT 32 Turnback Mileage of 3.75

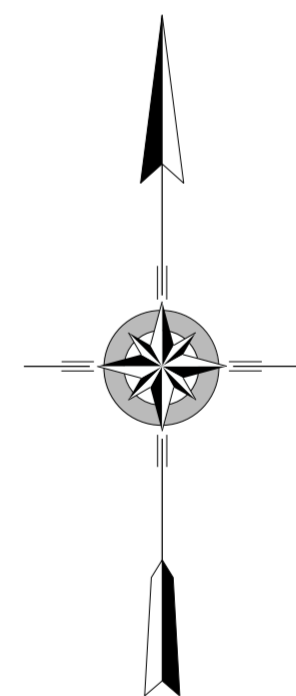

**UPPER AUGUSTA
SECOND CLASS TOWNSHIP MAP
NORTHUMBERLAND COUNTY**

PREPARED BY THE
PENNSYLVANIA DEPARTMENT OF TRANSPORTATION
BUREAU OF PLANNING AND RESEARCH
GEOGRAPHIC INFORMATION DIVISION
IN COOPERATION WITH THE
U.S. DEPARTMENT OF TRANSPORTATION
FEDERAL HIGHWAY ADMINISTRATION
MUNICIPAL CODE 49 217

REVISED PER FORM 990 DATED 1-6-12

